

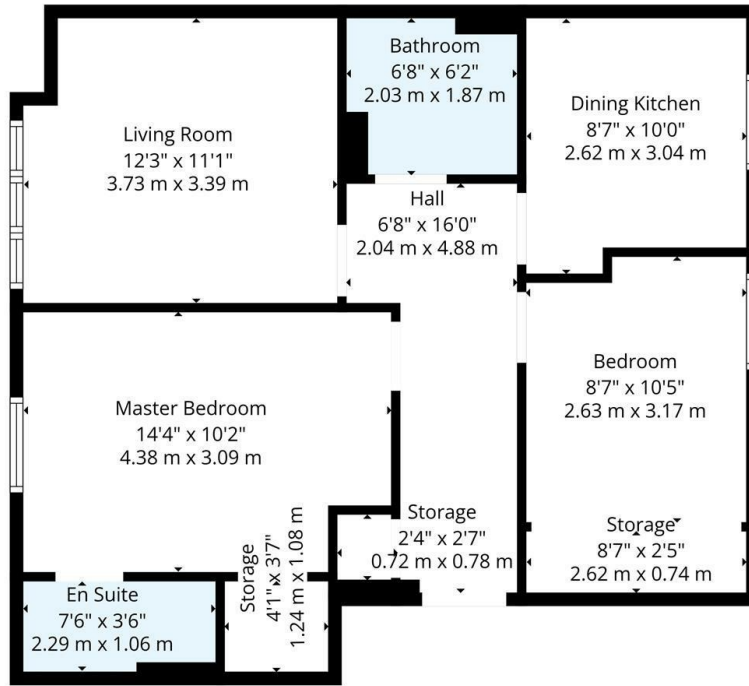

## 17 Investment Way, Glasgow, G43 1AN

Offers Over £165,000

- Modern ground floor apartment
- Spacious lounge overlooking the rear of the flat
- Gas central heating and double glazing
- EER Band B
- Two spacious double sized bedrooms
- Modern Kitchen and modern family bathroom
- Residents parking
- En-suite shower room off main bedroom
- Security entry
- Close proximity to Silverburn



**TOTAL: 626 sq. ft, 58 m2**  
 1st floor: 626 sq. ft, 58 m2  
 EXCLUDED AREAS: STORAGE: 43 sq. ft, 4 m2, WALLS: 54 sq. ft, 5 m2  
Floor Plan Created by Cubicase App. Measurements Deemed Highly Reliable But Not Guaranteed.

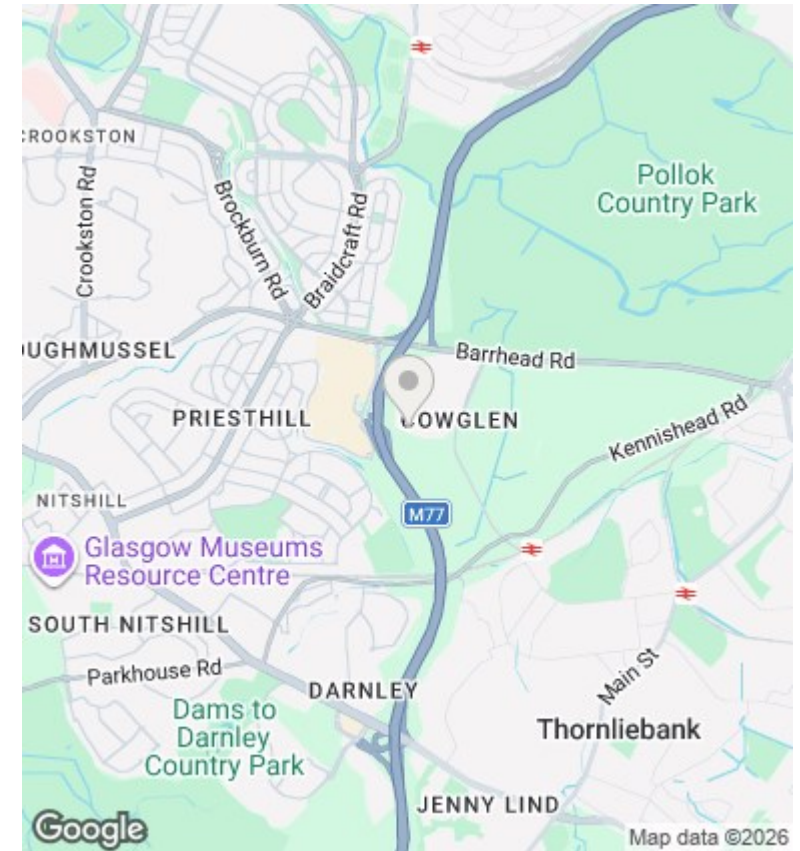

## Directions

## Viewings

Viewings by arrangement only. Call 01417262111 to make an appointment.

## Council Tax Band

## EPC Rating:

B

